The logo features the word "SUNSURIA" in a bold, white, sans-serif font. Below it, the word "forum" is written in a white, lowercase, cursive script. To the right of "forum", the text "C-SUITES" is displayed in a white, uppercase, sans-serif font, enclosed within a white rectangular box.

**SUNSURIA**  
*forum* C-SUITES

BUILDING FUTURES,  
CONNECTING WORLDS

## THE ENTREPRENEURIAL BUSINESS HUB

The Sunsuria Forum C-Suites is the tallest office tower in Shah Alam, featuring a 39-storey structure comprising 346 units ranging from 624 sq.ft. to 14,400 sq.ft. This wide range of unit sizes accommodates a variety of businesses.

The development offers inspiring and life-enriching facilities, making Sunsuria Forum C-Suites an outstanding choice for businesses of all types.



## EXPERIENCE MODERN ELEGANCE AT SUNSURIA FORUM'S PREMIER CORPORATE ADDRESS

Step into a stylish workspace where modern functionality meets streamlined spaces! Conquer the exclusive corporate address at Sunsuria Forum, filled with creative spaces and inspiring facilities.

- Freehold
- Levels 9 - 29 : Split Air-Conditioning System  
Levels 30 - 39 : Centralised Air-Conditioning System
- Grand Double Volume Lobby

Building Facade - Artist Impression



Illustration of Corporate Office Unit - Artist Impression

## YOUR ULTIMATE WORKSPACE SOLUTION

Experience a new era of flexible workspaces. Elevate your office experience with a premium solution designed to inspire your team.



Iconic Landmark



Seamless Transport links and Accessibility



Integrated Development with Diverse Amenities



Multi-Tier Security



Flexible Office Spaces



Prestigious Corporate Address



Trusted Developer



Life-Enriching Facilities



Connected to Lifestyle Mall



Lease or Purchase Options



Gym at Level 9 - Actual Photo

## EXPERIENCE LIFE-ENRICHING FACILITIES

Elevate your work-life balance at Level 9, a sky-high retreat surrounded by lush greenery. Enjoy jogging, hosting BBQs, or taking a refreshing swim to unwind after a productive day.

## FACILITIES (LEVEL 9)

- Courtyard Garden
- Jogging Track
- Lounge Pool & Sundeck
- Amarillo Starlight Pool
- Terrace Jacuzzi
- Gym
- Surau
- Changing Room
- Multipurpose Hall
- Thematic Planting Islands
- People's Junction
- Community Pod
- BBQ Pit
- Shaded Pavilion
- Water Feature with Seating
- Toddler Land
- ABC 123 Stepping
- Yoga / Tai Chi Deck
- Diamond Reflexology Trail
- Serene Lawn
- Business Centre



Amarillo Starlight Pool Overlooking Setia Alam - Artist Impression

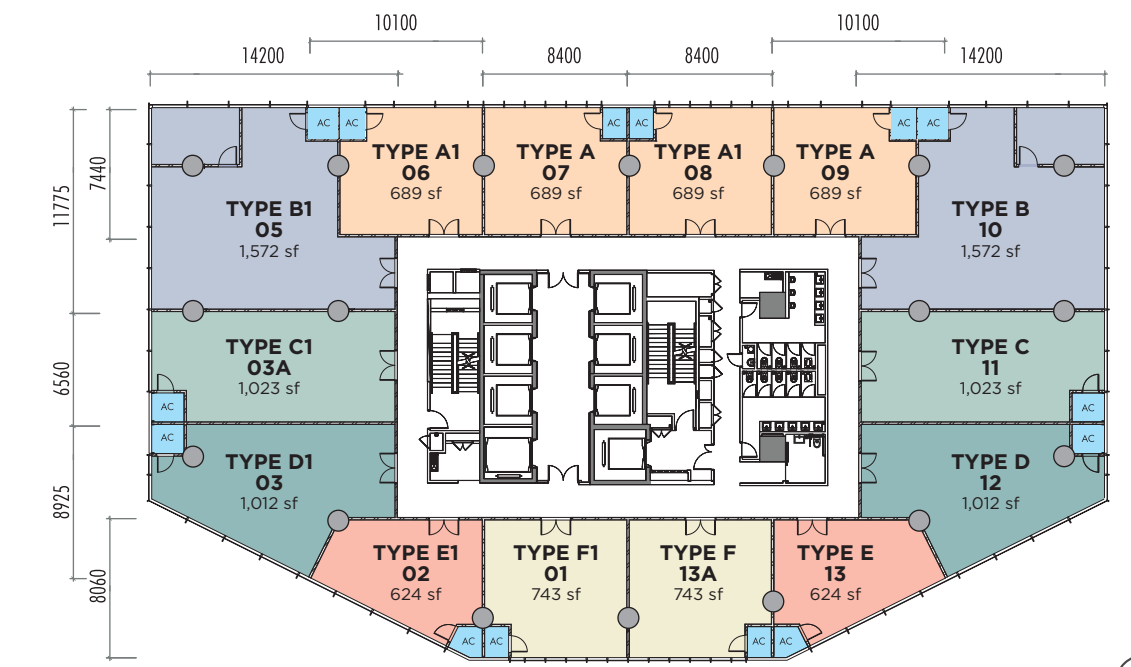

LEVELS 10-23, 25-29

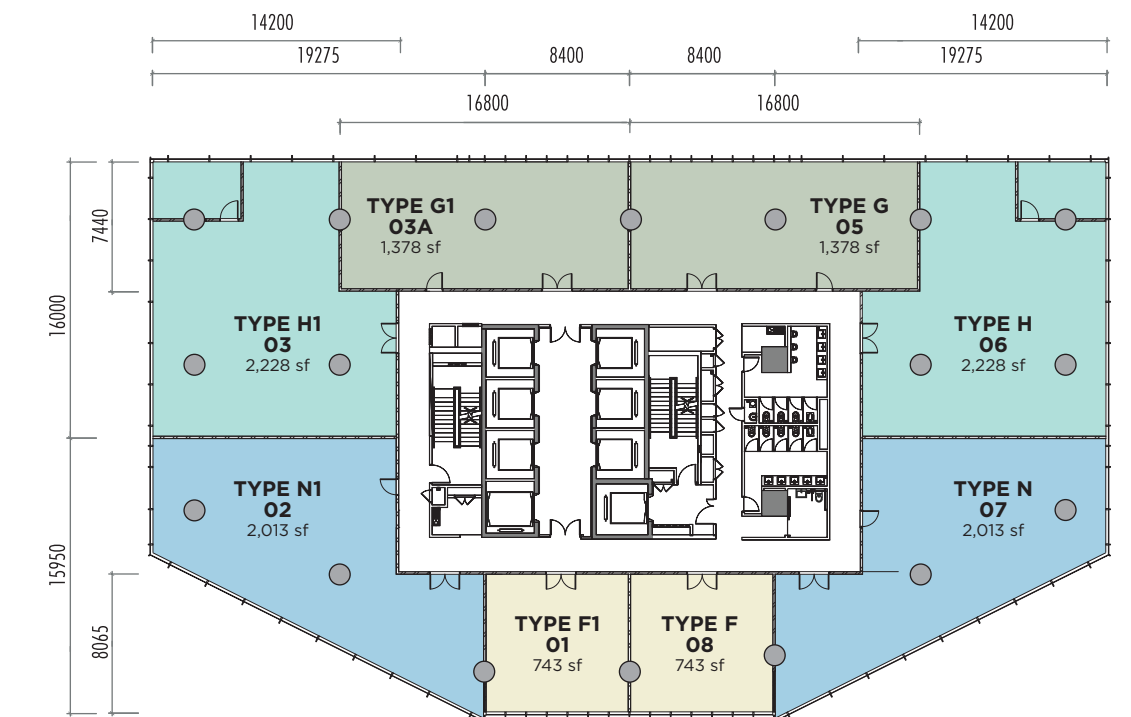

LEVELS 31-36

## SPECIFICATION

Structure	Reinforced Concrete
Wall	Brick / Dry Partition
Roofing	Reinforced Concrete
Ceiling	Concrete off-Form / Skimcoat
Window	Aluminium Framed Window
Doors	Office Main Door: Solid Door Plywood Flush Door/ Aluminium Framed Glass Door

Ironmongery	Quality Locksets
Wall Finish	Plaster / Skim Coat
Floor Finish	Concrete Finish
Electrical Installation	Isolator: 1 Fibre Wall Socket: 1

# SEAMLESS CONNECTIVITY

Sunsuria Forum's strategic location in Setia Alam provides seamless connectivity to a diverse range of amenities and popular destinations in the area. Offering access to enriching experiences within reach.

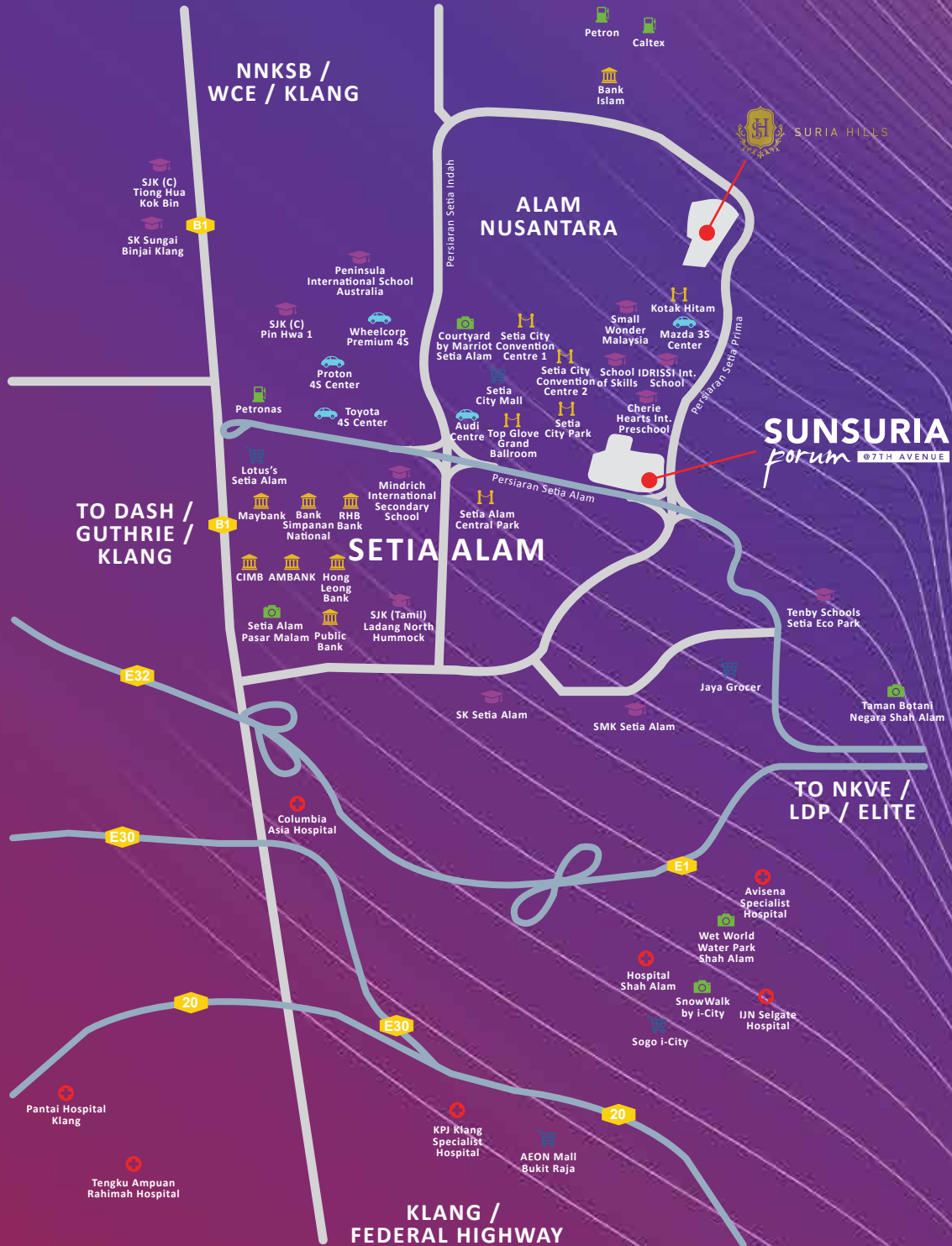

A PROUD DEVELOPMENT BY

# SUNSURIA

BUILDING TODAY CREATING TOMORROW

Sunsuria Forum Sdn Bhd  
 (71889234)  
 Suite 8, Main Tower, Sunsuria Avenue,  
 Persiaran Mahogany, Kota Damansara, PJU 5,  
 47810 Petaling Jaya, Selangor Darul Ehsan.



Sunsuria Forum  
 @ 7th Avenue

www.sunsuria.com  
**012 825 0777**  
 f Sunsuria Berhad @sunsuriaberhad



The information contained in this material is subject to change and cannot form part of an offer or contract. All renderings are artist's impressions only. All measurements are approximate. While every reasonable care has been taken in preparing this material, the developer cannot be held responsible for any inaccuracy. All the above items are subject to variations, modifications and substitutions as may be required by the Authorities or recommended by the Architect or Engineer.